

These capacitors have been developed especially for **charge – discharge applications** such as AC servo motors, lamp flash, X-ray, etc.

► Specifications /

Items	Characteristics
Temperature range	-25°C ~ + 105°C
Rated voltage	400VDC - 450VDC
Surge voltage	Repetitive max. 30 sec per 6 Minutes
Leakage current at 20°C	0.02 · C · V _r [μA] or 3 mA, which is smaller.
Capacitance tolerance	+/- 20%
Useful life	6000h at 105°C
Charge – Discharge	ΔV = 150VDC, f = 6Hz guaranteed life ≥ 50 Mio cycles at 40°C



► Outline Drawing /

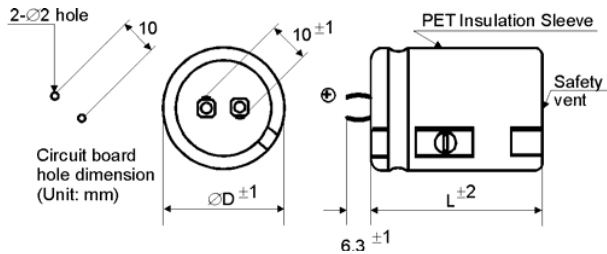

Form / Shape: R (Standard)
C (with short pin 4 ± 1mm)

► Ripple Current Multiplier /

Frequency [Hz]	50/60	120	300	1k	≥ 10k
multiplier	0.7	1.0	1.1	1.3	1.4

Forced cooling [m/sec]	v < 1.0	v ≥ 1.0
multiplier	1.0	1.1

Temperature [°C]	40	60	70	85	105
multiplier	2.3	1.9	1.7	1.4	1.0

► Product Code /

Example: DH 400V 100μF ±20% 22x25mm Shape „R“

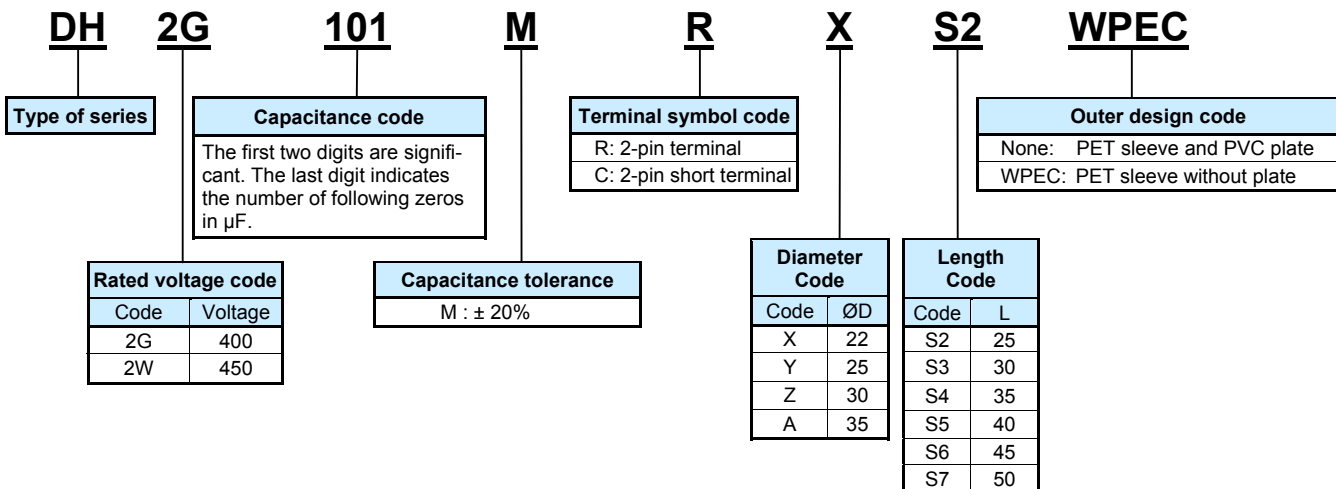

Rated Voltage Code (Surge Voltage) V_r [V DC]	Capacitance C_r [μ F]	Dissipation factor $\tan \delta$	Ripple Current	Ripple Current	ESR (typ) at 20°C/100Hz [m Ω]	DxL [mm]	Product Code
			at 40°C/120Hz [A RMS]	at 105°C/120Hz I_r [A RMS]			
400 2G (450)	100	0.20	1.77	0.77	1100	22x25	DH2G101M□XS2
	120	0.20	2.05	0.89	920	25x25	DH2G121M□YS2
		0.20	2.07	0.90	920	22x30	DH2G121M□XS3
	150	0.20	2.44	1.06	730	22x35	DH2G151M□XS4
	180	0.20	2.62	1.14	610	25x30	DH2G181M□YS3
		0.20	2.76	1.20	610	22x40	DH2G181M□XS5
	220	0.20	2.92	1.27	500	30x25	DH2G221M□ZS2
		0.20	3.06	1.33	500	25x35	DH2G221M□YS4
		0.20	3.17	1.38	500	22x45	DH2G221M□XS6
	270	0.20	3.34	1.45	410	35x25	DH2G271M□AS2
		0.20	3.38	1.47	410	30x30	DH2G271M□ZS3
		0.20	3.52	1.53	410	25x40	DH2G271M□YS5
		0.20	3.63	1.58	410	22x50	DH2G271M□XS7
	330	0.20	3.93	1.71	330	30x35	DH2G331M□ZS4
		0.20	4.05	1.76	330	25x45	DH2G331M□YS6
		0.20	4.26	1.85	330	35x30	DH2G331M□AS3
	390	0.20	4.23	1.84	280	35x30	DH2G391M□AS3
		0.20	4.46	1.94	280	30x40	DH2G391M□ZS5
	470	0.20	4.83	2.10	230	35x35	DH2G471M□AS4
		0.20	5.06	2.20	230	30x45	DH2G471M□ZS6
0.20		5.22	2.27	230	35x40	DH2G471M□AS5	
560	0.20	5.50	2.39	200	35x40	DH2G561M□AS5	
	0.20	5.70	2.48	200	30x50	DH2G561M□ZS7	
680	0.20	6.26	2.72	160	35x45	DH2G681M□AS6	
450 2W (500)	82	0.20	1.61	0.70	1220	22x25	DH2W820M□XS2
	100	0.20	1.86	0.81	1000	25x25	DH2W101M□YS2
		0.20	1.91	0.83	1000	22x30	DH2W101M□XS3
	120	0.20	2.16	0.94	830	25x30	DH2W121M□YS3
		0.20	2.19	0.95	830	22x35	DH2W121M□XS4
	150	0.20	2.42	1.05	660	30x25	DH2W151M□ZS2
		0.20	2.53	1.10	660	22x40	DH2W151M□XS5
		0.20	2.53	1.10	660	25x35	DH2W151M□YS4
	180	0.20	2.76	1.20	550	25x35	DH2W181M□YS4
		0.20	2.85	1.24	550	22x45	DH2W181M□XS6
	220	0.20	3.01	1.31	450	35x25	DH2W221M□AS2
		0.20	3.06	1.33	450	30x30	DH2W221M□ZS3
		0.20	3.29	1.43	450	25x45	DH2W221M□YS6
	270	0.20	3.52	1.53	370	35x30	DH2W271M□AS3
		0.20	3.57	1.55	370	30x35	DH2W271M□ZS4
		0.20	3.77	1.64	370	25x50	DH2W271M□YS7
	330	0.20	4.05	1.76	300	35x35	DH2W331M□AS4
		0.20	4.09	1.78	300	30x40	DH2W331M□ZS5
	390	0.20	4.58	1.99	260	35x40	DH2W391M□AS5
		0.20	4.76	2.07	260	30x50	DH2W391M□ZS7
470	0.20	5.20	2.26	210	35x45	DH2W471M□AS6	
560	0.20	5.84	2.54	180	35x50	DH2W561M□AS7	

